



GLC Coupe

Brief overview

Mercedes-Benz



Cockpit overview

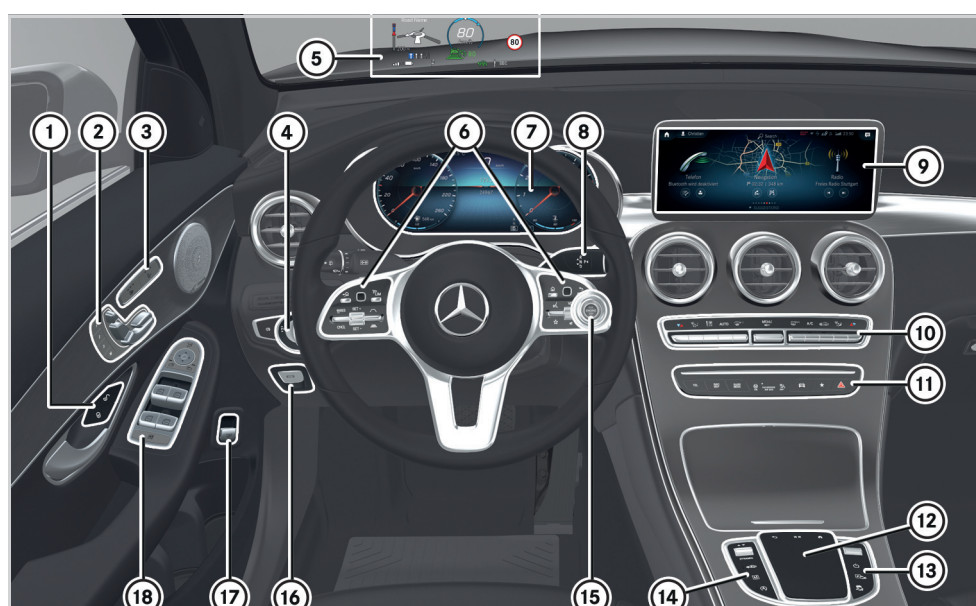

- ① **Door handle**
 - Locks the vehicle centrally
 - Unlocks the vehicle centrally
- ② **Seat functions**
 - Adjusts the seat electrically
 - Memory function and presets
 - 1 2 3
- ③ Switches the seat heater on/off
- Switches the seat ventilation on/off
- ④ Light switch
- Rear fog lamp
- ⑤ Head-up Display
- ⑥ Multifunction steering wheel control panels
- ⑦ Multifunction display
- ⑧ DIRECT SELECT lever
- ⑨ Media display of the MBUX multimedia system
- ⑩ Climate control system control panel

⚠ WARNING Make sure that you read the entire Operator's Manual. Otherwise, you may not recognize dangers.

Cockpit overview

- ⑪ **MBUX Main functions**
 - Calls up telephone
 - Calls up navigation
 - Calls up radio or media
 - Calls up vehicle functions (e.g. assistance systems)
 - Favorites button
 - i** Press and hold: adds a favorite
 - Hazard warning lights
- ⑫ **MBUX multimedia system touchpad**
 - Back button
 - Press: audio control menu
Swipe: next/previous track or radio station
 - Displays Home screen
- ⑬ **Buttons on the right of the touchpad**
 - Adjusts the volume
 - Press briefly: mute function
Press and hold: switches off the MBUX multimedia system
 - Active Parking Assist
 - ESP[®] OFF

- ⑭ **Buttons on the left of the touchpad**
 - DYNAMIC SELECT
 - Vehicle level
 - Manual gearshifting
 - ECO start/stop function
 - i** The ECO start/stop function cannot be permanently deactivated.
- ⑮ Start/stop button for starting/stopping the engine
- ⑯ Electric parking brake
- ⑰ Opens or closes the trunk lid
- ⑱ Door control panel with controls for power windows, exterior mirror settings and the override feature for the rear side windows
 - i** If the front passenger mirror is selected and you engage reverse gear, the front passenger mirror moves into the stored parking position.



Overhead control panel

- ① Buttons for interior lighting and reading lights
- ② Button for Mercedes me connect*
- ③ SOS button* (Mercedes-Benz emergency call system)
- ④ Opens/closes the sliding sunroof
Roller sunblind

* Not available in all countries

Note that your vehicle may not be equipped with all features described.

Operating elements on the steering wheel and Active Distance Assist DISTRONIC

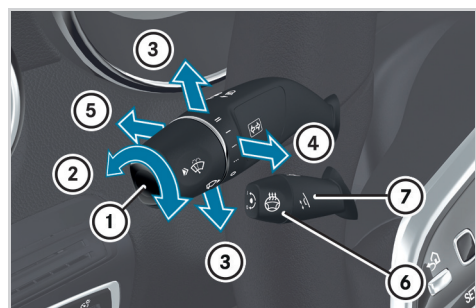

- ① Wipes the windshield once
Wipes with washer fluid
- ② Sets the windshield wipers
Off, normal/frequent interval wiping, slow/fast continuous wiping
- ③ Turn signal, left/right
- ④ Headlamp flashing
- ⑤ Adaptive Highbeam Assist Plus
- ⑥ Switches the steering wheel heater on/off
- ⑦ Adjusts the steering wheel

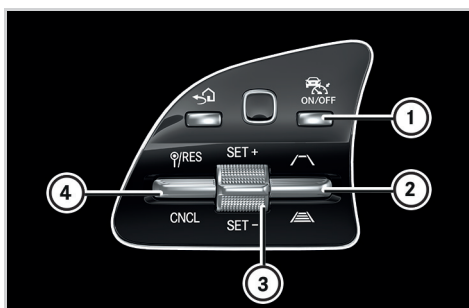

- ① Activates or deactivates Active Distance Assist DISTRONIC
- ③ Active Distance Assist
 Activates DISTRONIC with current speed
- ④ Activates with the stored speed/pulls away with Active Distance Assist DISTRONIC
- Deactivates Active Distance Assist DISTRONIC

Changing the speed/distance

- ② Reduces the specified minimum distance
- Increases the specified minimum distance
- ③ Increases the speed
 Reduces the speed

Active Distance Assist DISTRONIC maintains a constant speed which has been stored. The lowest speed that can be set is 12 mph (20 km/h).

You can change the set speed:

- ▶ 1 mph step (1 km/h):** briefly press rocker switch ③ up or down.
- ▶ 5 mph step (10 km/h):** push rocker switch ③ up or down beyond the pressure point.

Using rocker switch ②, you can change the specified minimum distance to the vehicle in front. The specified minimum distance depends on the currently driven speed.

⚠ WARNING Make sure that you read the entire Operator's Manual. Otherwise, you may not recognize dangers.

Climate control



Operating possibilities
You can adjust climate control using the buttons on climate control panel ①. If you change any settings, media display ② briefly shows the current settings of the climate control system.

Air conditioning control panel

- Sets the temperature
 - Sets the air distribution
 - Sets the air flow, switches automatic climate control off completely
 - Sets climate control to automatic mode
 - Defrosts the windshield
 - Calls up the climate control menu
- If you press and hold the **MENU** button for approximately 4 seconds, automatic climate control will be reset to the basic settings.
- Residual heat with the engine off
- Defrosts the rear window
 - Synchronized operation
 - Air-recirculation mode
The air in the interior is recirculated; the windows may fog up more quickly.
 - Cooling with air dehumidification

General notes

Optimum climate control is achieved only with the side windows and roof closed. To prevent the windows from misting up, please observe the following information:

- Switches on the cooling function. In warm weather, the air inside the vehicle will be cooled. This function also dries the air inside the vehicle.
- As far as possible, do not switch off climate control
- Switches on air-recirculation mode only briefly
- If necessary, briefly switch on the windshield defroster function

Note that your vehicle may not be equipped with all features described.

Buttons on the multifunction steering wheel



- ⑥ Accepts a telephone call
- Rejects a telephone call
Ends a call
Ends a dialog with the Voice Control System
- ⑦ Adjusts the volume
Press: switches sound on or off
- ⑧ Starts a dialog with the Voice Control System
- i** Press and hold: activates the voice control system of the mobile end device currently connected
- Displays favorites

Operating the multifunction display

- ① Back/Home button
 - i** Press and hold: shows the standard display (speedometer, trip meter and rev counter)
- ② Touch Control for the multifunction display
Press: confirms your selection

Operating the MBUX multimedia system

- ③ Home screen
- ④ Touch Control for the MBUX multimedia system
Press: confirms your selection
- ⑤ Back button
Ends a dialog with the Voice Control System



Multifunction display



WARNING Make sure that you read the entire Operator's Manual. Otherwise, you may not recognize dangers.

Adjusting the multifunction display

Content ④ can be freely selected.

- ▶ Swipe Touch Control ② to the left or right to wipe. The selected area will be highlighted.
- ▶ Swipe Touch Control ② up or down in order to select the desired display content.

The index points ⑥ show the selected display content.

Operating the menu bar

Content ⑤ can be set using menu bar ③.

- ▶ **To call up the menu bar:** press button ①.
- ❗ If you press and hold button ①, the standard display of the multifunction display is shown.
- ▶ **To select content:** swipe Touch Control ② to the left or right and press to confirm the menu.

Head-up Display and MBUX Interior Assistant

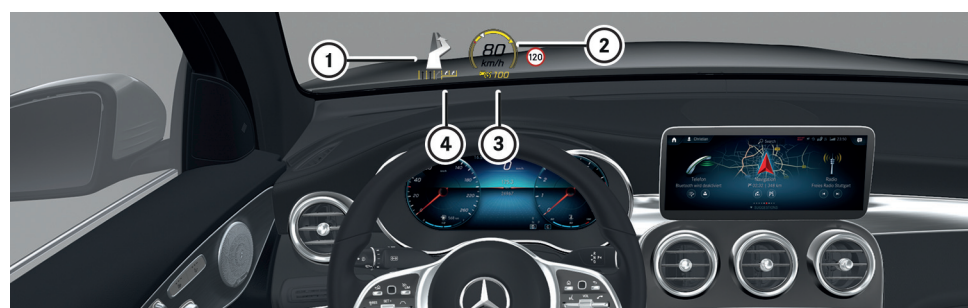

- ① Navigation messages
- ② Current speed
- ③ Detected instructions and traffic signs
- ④ Speed set in the driving assistance system (e.g. Active Distance Assist DISTRONIC)

Head-up Display

The Head-up Display projects the following into the field of vision of the driver:

- Information from the navigation system
- Information from the driving assistance systems
- Some warning messages

Switching the Head-up Display on/off

Multimedia system:

▶ Settings Quick Access

- ▶ Select HUD. The Head-up Display is activated.

Note that your vehicle may not be equipped with all of the features described.



MBUX Interior Assistant

The MBUX Interior Assistant recognizes certain hand movements and gestures made between the Media Display and the center console, including those made on the touchpad. For example, you can switch the reading light on/off by using the back of the hand to briefly touch the rear view mirror. Further control functions:

- Operation of functions by moving the hand closer to the touchscreen or touchpad, e.g. adjusting seat settings.
- Calling up a previously stored favorite with a hand movement.

MBUX multimedia system Home screen

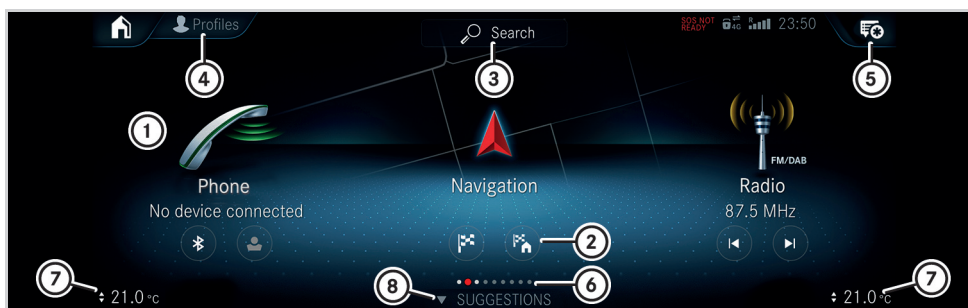

- ① Main applications
- ② Quick-access (e.g. direct destination entry or navigating home)
- ③ Global search (search for functions in the system, e.g. Music or Navigation, as well as those external to the system, e.g. Internet)
- ④ Creates, modifies and switches profiles You can, for example, store the seat and steering wheel position, multifunction display contents, ambient lighting settings, favorites and personalized suggestions.
- ⑤ Calls up the notification center
- ⑥ Number of applications and the currently selected display area
- ⑦ Calls up the air conditioning menu
- ⑧ Calls up favorites/suggestions and themes

WARNING Make sure that you read the entire Operator's Manual. Otherwise, you may not recognize dangers.

Voice Control System (for infotainment, navigation and vehicle functions)

Starting a dialog

For the dialog with the Voice Control System, you can use complete sentences as voice commands.

- ▶ **Activation with a keyword:** Say "Hi Mercedes" and combine it with a voice command or a question.

or

- ▶ **Activation using the rocker switch on the multifunction steering wheel:** Press up and after the acoustic signal say a voice command or a question.

Help functions

- **Optimum operation:** Say the "Help Voice Control System" voice command.
- **Help for the current function:** Say the "Help" voice command during the dialog.
- **Help for a specific system:** Say the voice command for the desired system, e.g. "Help telephone".

You can change the language via the system language settings. If the Voice Control System does not support the set system language, English is selected.

Selected examples

Navigation voice commands

- "Navigate to 25 Woodward Avenue, Detroit" Starts route guidance to an address. The order of the road, town or building number is irrelevant.
- "Navigate to John Doe" Starts route guidance to a contact from your address book.
- "Show alternative routes" The navigation shows alternative routes for route guidance.
- "Navigate to nearest gas station" Starts route guidance to the nearest gas station.

Telephone voice commands

- "Call John Doe" The telephone number of a stored contact is dialed.
- "Read out new text messages" All new text messages will be read out.
- "Call my father on his cell number." The telephone number of the contact "Father cell" will be called.

Media/radio voice commands

- "Switch to station Z100" If you are listening to the radio, you can say the name of a station to which you would like to listen.
- "Play Bob Dylan" The system searches through the names of all available albums, tracks, artists, music genres and playlists. If the result is unambiguous, playback starts immediately.

Vehicle voice commands

- "Open the Assistance menu"
- "Temperature to 72 °F (22 °C)"
- "When is the next service due?"
- "Front passenger reading light on"
- "Ambient lighting to blue"
- "Head-up Display on/off"

Online voice commands

- ❗ To use this feature, you must have a connection to the Internet.
- "What will the weather be like tomorrow in Nashville?"
- "Is it raining at my destination?"

Note that your vehicle may not be equipped with all features described.

Bluetooth® connection and external media sources

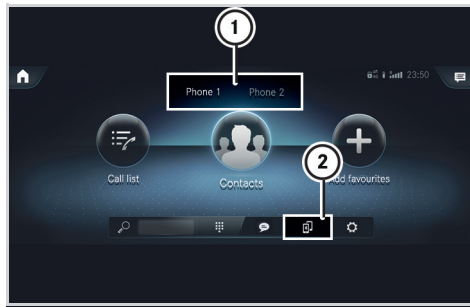

- ① Changing mobile phones
- ② Device manager

Connecting a mobile phone

Requirements:

Bluetooth® is switched on on the mobile phone and the device is visible for other devices (see the manufacturer's operating instructions).

- ▶ On the MBUX multimedia system, select Phone .

Searching for a mobile phone

- ▶ Select **Connect New Device**.
- ▶ Select the desired mobile phone.

If your mobile phone is not found, try searching on the mobile phone itself.

Authorizing a mobile phone

- ▶ A code is displayed in the multimedia system and on the mobile phone.
- ▶ **If the codes match:** confirm the code on the mobile phone.

Further information

Detailed information on Bluetooth® connections with your mobile phone can be found at:

www.mercedes-benz.com/connect

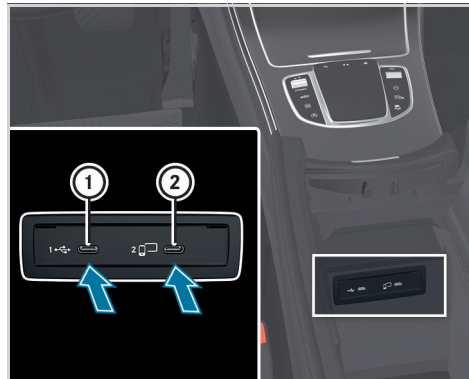

Connecting external media sources

- ① USB connection (type C)
- ② USB connection for Apple CarPlay™ or Android Auto™

Depending on the vehicle equipment, there are further USB ports in the stowage compartment in the front center console or in the rear folding compartment.

WARNING Make sure that you read the entire Operator's Manual. Otherwise, you may not recognize dangers.

Further information on your vehicle



HANDS-FREE ACCESS

If you carry the KEYLESS-GO key on your person, you will be detected by a sensor. Do not touch the bumper and maintain a distance of around 12 in (30 cm).

- ▶ **To open or close:** kick into the center of the sensor detection range under the bumper with your foot.

- ❗ The kicking movement must be towards the vehicle and back again, and it must not be carried out too slowly.



Deactivating the KEYLESS-GO key function

If you wish to reduce the energy consumption of the key, you can deactivate the KEYLESS-GO function.

- ▶ **To deactivate:** press twice in succession on button ①. The battery check lamp of the key lights up twice briefly and once for a longer period.

- ▶ **To activate:** press any button on the key.

Further information

Further information about Mercedes-Benz vehicles and about Daimler AG can be found on the following website:

<http://www.mbusa.com>

Mercedes-Benz Guides app

The Mercedes-Benz Guides app contains the complete Operator's Manual and is available free-of-charge in the familiar app stores.



How-To Videos



Operator's Manuals

Registering in the Mercedes me portal

Registering in the Mercedes me portal in order to be able to use the full scope of your vehicle's functions.



Note that your vehicle may not be equipped with all of the features described.