



2385842007

Order no. P238 0659 13 Part no. 238 584 20 07
Edition B2020



E-Class Convertible

Mercedes-AMG Supplement

Mercedes-Benz



Publication details

Internet

Further information about Mercedes-Benz vehicles and about Daimler AG can be found on the following websites:

<https://www.mbusa.com> (USA only)

<https://www.mercedes-benz.ca> (Canada only)

Documentation team

©Daimler AG: not to be reprinted, translated or otherwise reproduced, in whole or in part, without written permission from Daimler AG.

Vehicle manufacturer

Daimler AG

Mercedesstrasse 137

70327 Stuttgart

Germany

As at 25.03.2019

Thank you for purchasing a Mercedes-AMG

Before you first drive off, read this Operator's Manual carefully and familiarize yourself with your vehicle. For your own safety and a longer operating lifespan of the vehicle, follow the instructions and warning notices in this Operator's Manual. Disregarding them may lead to damage to the vehicle or injury to people.

Damage to the vehicle resulting from the disregard of the instructions is not covered by the Mercedes-Benz Limited Warranty.

The standard equipment or product description of your vehicle may vary and depends on the following factors:

- Model
- Order
- National version
- Availability

Mercedes-AMG reserves the right to introduce changes in the following areas:

- Design
- Equipment

- Technical features

The equipment in your vehicle may therefore differ from that shown in the descriptions and illustrations.

The following documents are integral parts of the vehicle:

- Digital Operator's Manual
- Printed Operator's Manual
- Maintenance Booklet
- Equipment-dependent Supplements

Keep these documents in the vehicle at all times. If you sell the vehicle, always pass all of the documents on to the new owner.

Mercedes-Benz USA, LLC
Mercedes-Benz Canada, Inc.
A Daimler Company

2385842007



Symbols	3	Instrument Display and on-board computer	24	Vehicle data	38
At a glance	4	Notes on the Instrument Display and on-board computer	24	Display messages and warning/indicator lamps	41
Cockpit	4	Operating the on-board computer	24	Display messages	41
General notes	7	Calling up displays on the Performance menu	25	Warning and indicator lamps	41
Operator's Manual	7	Displaying and starting RACE TIMER on the Performance menu	27	Index	44
Operating safety	7	Function of the Head-up Display	28		
Qualified specialist workshop	8	Multimedia system	30		
Correct use of the vehicle	9	AMG TRACK PACE	30		
Limited Warranty	9	Breakdown assistance	35		
Occupant safety	10	Flat tire	35		
Seat belts	10	Wheels and tires	36		
Driving and parking	11	Changing a wheel	36		
Driving	11	Technical data	37		
DYNAMIC SELECT switch	13	Operating fluids	37		
Automatic transmission	14				
Driving and driving safety systems	16				
Function of the AMG steering-wheel buttons	23				

In this Operator's Manual, you will find the following symbols:

⚠ DANGER Danger due to not observing the warning notices

Warning notices draw your attention to hazards that may endanger your health or life, or the health or life of others.

▶ Observe the warning notices.

🌿 ENVIRONMENTAL NOTE Environmental damage due to failure to observe environmental notes

Environmental notes include information on environmentally responsible behavior or environmentally responsible disposal.

▶ Observe environmental notes.

! NOTE Damage to property due to failure to observe notes on material damage

Notes on material damage inform you of risks which may lead to your vehicle being damaged.

▶ Observe notes on material damage.

ⓘ Useful instructions or further information that could be helpful to you.

▶ Instruction

(→ page) Further information on a topic

Display Information on the multifunction display/media display



Highest menu level, which is to be selected in the multimedia system



Corresponding submenus, which are to be selected in the multimedia system

* Marks a cause

4 At a glance – Cockpit

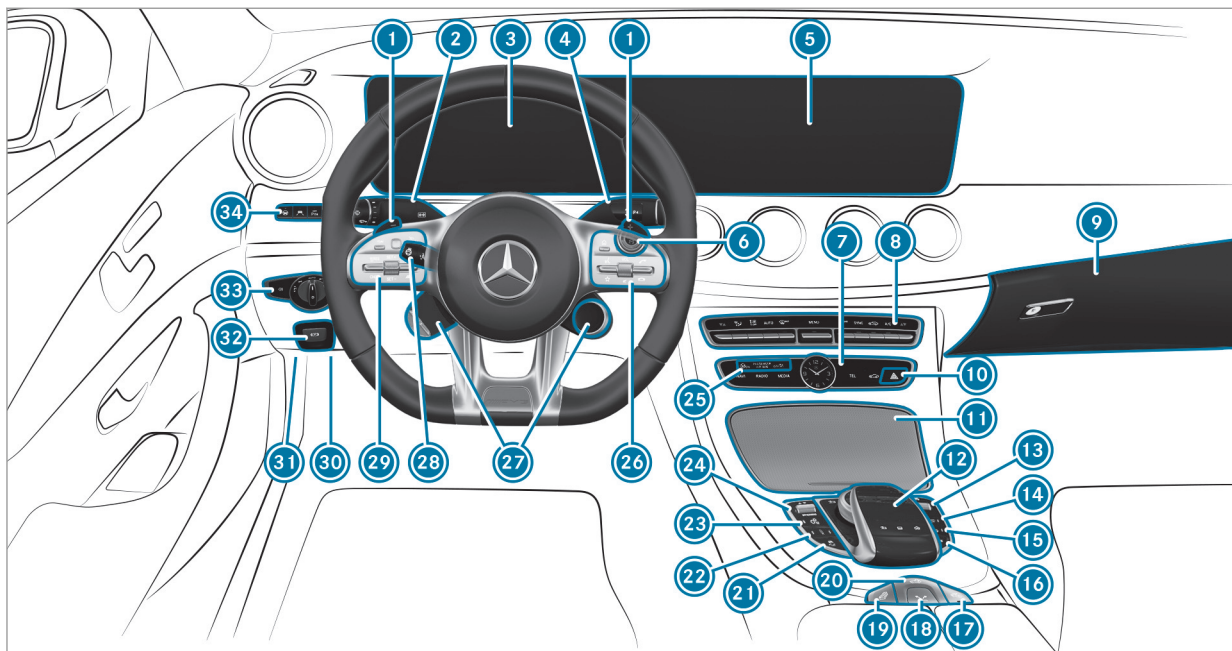

Left-hand drive vehicles

①	Steering wheel gearshift paddles	→	14	⑩	Hazard warning lights		
②	Combination switch			⑪	Stowage compartment		
③	Instrument Display	→	24	⑫	Touchpad		
④	DIRECT SELECT lever			⑬	Control knob for volume and switching sound on/off		
⑤	Media display				Switches the multimedia system on/off		
⑥	Start/stop button	→	11	⑭	AMG Performance exhaust system	→	13
⑦	Calls up the main functions			⑮	ECO start/stop function	→	12
⑧	Climate control systems			⑯	Active Parking Assist		
⑨	Glove box			⑰	Activates/deactivates AIRCAP		
				⑱	Opens the stowage compartment		
				⑲	Opens/closes the side windows		
				⑳	Opens/closes the soft top		
				㉑	ESP®	→	16
				㉒	AMG adaptive sport suspension system	→	18
				㉓	Manual gearshifting	→	14
				㉔	DYNAMIC SELECT switch	→	13
				㉕	PASSENGER AIR BAG indicator lamp		
				㉖	Control panel for multimedia system		
				㉗	AMG steering-wheel buttons	→	23
				㉘	Adjusts the steering wheel		
					Switches the steering wheel heater on/off		
				㉙	Operating group:		
					On-board computer	→	24
					Cruise control		

6 At a glance – Cockpit

Active Distance Assist DISTRONIC

- 30 Diagnostics connection
- 31 Opens the hood
- 32 Electric parking brake
- 33 Light switch
- 34 Control panel for:

Active Steering Assist

- Active Lane Keeping Assist
- Parking Assist PARKTRONIC
- Head-up Display
- Sets the vehicle level

Operator's Manual

This Supplement provides information on all the important functions of your AMG vehicle that are either not described or differ from the descriptions in the vehicle Operator's Manual. This information supplements or replaces the corresponding sections in the vehicle Operator's Manual. Under no circumstances does the Supplement replace the Operator's Manual.

This Supplement describes all models, and standard and optional equipment for your vehicle, as available at the time of going to press. Country-specific differences are possible. Bear in mind that your vehicle may not feature all functions described here. This is also the case for systems and functions relevant to safety. Therefore, the equipment on your vehicle may differ from that in the descriptions and illustrations.

The original purchase contract documentation for your vehicle contains a list of all of the systems in your vehicle.

Should you have any questions concerning equipment and operation, please consult an authorized Mercedes-Benz Center.

The Operator's Manual, the Supplement and the Maintenance Booklet are important documents and should be kept in the vehicle.

Operating safety

▲ WARNING Risk of accident due to malfunctions or system failures

If you do not have the prescribed service/maintenance work or any required repairs carried out, this could result in malfunctions or system failures.

- ▶ Always have the prescribed service/maintenance work as well any required repairs carried out at a qualified specialist workshop.

▲ WARNING Risk of accident and injury as a result of incorrect modifications to electronic component parts

Modification to electronic components, their software or wiring could impair their function and/or the function of other networked component parts. In particular, systems relevant to safety could also be affected.

As a result, they may no longer function as intended and/or endanger the operating safety of the vehicle.

- ▶ Never tamper with the wiring and electronic component parts or their software.
- ▶ You should have all work on electrical and electronic components carried out at a qualified specialist workshop.

Observe the "On-board electronics" section in "Technical data" in the vehicle Operator's Manual.

⚠ WARNING Risk of fire due to flammable materials on hot parts of the exhaust system

Flammable material such as leaves, grass or twigs may ignite if they come into contact with hot parts of the exhaust system.

- ▶ When driving on unpaved roads or off-road, regularly check the vehicle underside.
- ▶ Remove trapped plants or other flammable material.
- ▶ If there is damage, consult a qualified specialist workshop immediately.

! NOTE Damage to the vehicle

In the following situations, in particular, there is a risk of damage to the vehicle:

- The vehicle becomes grounded, e.g. on a high curb or an unpaved road

- The vehicle is driven too fast over an obstacle, e.g. a curb, speed bump or pothole
- A heavy object strikes the underbody or chassis components

In situations such as this, the body, the underbody, chassis components, wheels or tires could be damaged without the damage being visible. Components damaged in this way can unexpectedly fail or, in the case of an accident, may not absorb the loads that arise as intended.

If the underbody paneling is damaged, flammable materials such as leaves, grass or twigs can collect between the underbody and the underbody paneling. These materials may ignite if they come into contact with hot parts on the exhaust system.

- ▶ Have the vehicle checked and repaired immediately at a qualified specialist workshop.

or

- ▶ If driving safety is impaired while continuing your journey, pull over and stop the vehicle immediately in accordance with the traffic conditions, and contact a qualified specialist workshop.

Qualified specialist workshop

An authorized Mercedes-Benz Center is a qualified specialist workshop. It has the necessary special skills, tools and qualifications to correctly carry out the work required on your vehicle. This particularly applies to safety-relevant works.

Always have the following work carried out on your vehicle at a qualified specialist workshop:

- Safety-relevant works
- Service and maintenance work
- Repair work
- Modifications as well as installations and conversions
- Work on electronic components

Mercedes-AMG recommends a Mercedes-Benz service center.

Correct use of the vehicle

If you remove any warning stickers, you or others could fail to recognize certain dangers. Leave warning stickers in position.

Observe the following information in particular when driving your vehicle:

- the safety notes in this manual
- technical data for the vehicle
- traffic rules and regulations
- laws and safety standards pertaining to motor vehicles

Limited Warranty

! **NOTE** Damage to the vehicle arising from violation of these operating instructions.

Damage to the vehicle can arise from violation of these operating instructions.

This damage is not covered either by the Mercedes-Benz implied warranty or by the New- or Used-Vehicle Warranty.

- ▶ Follow the instructions in these operating instructions on proper operation of your vehicle as well as on possible vehicle damage.

Seat belts

Function of the seat belt extender

The seat belt extender for the front seat helps you fasten your seat belt. When the door is closed, the seat belt extender extends.

The seat belt extender retracts again in the following cases:

- the seat belt tongue is engaged in the seat belt buckle
- The seat belt tongue is not engaged in the seat belt buckle within 60 seconds
- The respective door is opened
- You fold the seat backrest forwards
- Nobody is sitting in the front passenger seat

The seat belt extender must always be retracted while the vehicle is in motion.

Driving

Breaking-in notes

To preserve the engine during the first 1,000 miles (1,500 km):

- drive at varying road speeds and engine speeds.
- do not drive faster than 85 mph (140 km/h).
- allow the engine to reach a maximum engine speed of 4,500 rpm (4,500 rpm) only briefly.
- drive the vehicle in drive program **C**.
- change gear before the tachometer needle is $\frac{2}{3}$ of the way to the red area of the tachometer.
- do not shift down a gear manually in order to brake.
- avoid overstraining the vehicle, e.g. driving at full throttle.
- do not depress the accelerator pedal past the pressure point (kickdown).
- only increase the engine speed gradually and accelerate the vehicle to full speed after 1,000 miles (1,500 km).

This also applies when the engine or parts of the drivetrain have been replaced.

Please also observe the following breaking-in notes:

- In certain driving and driving safety systems, the sensors adjust automatically while a certain distance is being driven after the vehicle has been delivered or after repairs. Full system effectiveness is not reached until the end of this teach-in process.
- Brakepads, brake discs and tires that are either new or have been replaced only achieve optimum braking effect and grip after several hundred kilometers of driving. Compensate for the reduced braking effect by applying greater force to the brake pedal.

Function of Emotion Start

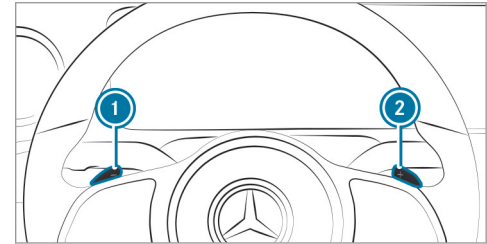

- ▶ Start the vehicle with the start/stop button and simultaneously pull one of steering wheel gearshift paddles ① or ②.
 - The idle speed is increased briefly when starting the engine.
 - The exhaust gas flaps are opened (sporty characteristic) (→ page 12).

Observe the notes on starting the vehicle in the vehicle Operator's Manual.

Operation of the ECO start/stop function

The engine is switched off automatically in the following situations if all vehicle conditions for an automatic engine stop are met:

- You brake the vehicle to a standstill in transmission position **D** or **N**.

If you switch on the HOLD function in transmission position **D** or **N**, the engine will automatically stop in the following situations:

- You stop behind a vehicle that is pulling away.
- You stop at a stop sign when there is no vehicle in front of you.
- You turn the steering wheel hard at a low speed.

- ⓘ In transmission position **R**, the engine is not switched off automatically even when the HOLD function is switched on.

The engine is restarted automatically if:

- You release the brake pedal in transmission position **D** when the HOLD function is not

active and the vehicle does not start to move.

- You shift from transmission position **P**.
- You release the brake pedal and the vehicle starts to move on a gentle downhill gradient at a speed below 3 mph (5 km/h).
- You depress the accelerator pedal.
- You permanently activate manual gearshifting.
- You pull the left-hand steering wheel gearshift paddle.
- You open or close the soft top.
- An automatic engine start is necessary.

If the engine was switched off by the ECO start/stop function and you leave the vehicle, a warning tone sounds. The **Vehicle Ready to Drive Switch the Ignition Off Before Exiting** display message also appears in the multifunction display. If you do not switch off the ignition, the ignition is automatically switched off after one minute.

AMG Performance exhaust system

Function of the AMG Performance exhaust system

Changing the position of the exhaust gas flaps allows you to select the sound characteristics of the AMG Performance exhaust system:

- Closed exhaust gas flaps: comfort characteristic (balanced)
- Open exhaust gas flaps: sporty characteristic (powerful)

Operating the AMG Performance exhaust system

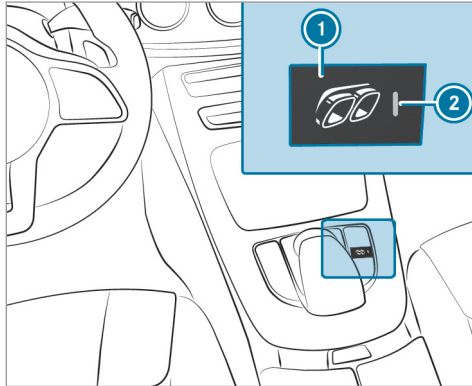







- ▶ Press button ①. The sporty characteristic (Powerful) is selected when indicator lamp ② lights up.

DYNAMIC SELECT switch

Function of the DYNAMIC SELECT switch

Use the DYNAMIC SELECT switch to change between the following drive programs:

-  **(Slippery)**: optimized pulling away and driving characteristics in wintry and slippery road conditions
-  **(Individual)**: individual settings
-  **(Comfort)**: comfortable and economical driving style
-  **(Sport)**: sporty driving style
-  **(Sport +)**: particularly sporty driving style

Mercedes-AMG recommends selecting the drive program  when in city traffic or stop-and-go traffic.

Depending on the drive program selected, the following vehicle characteristics will change:

- Drive:
 - Engine and transmission management
 - Active Distance Assist DISTRONIC
- ESP®

- Availability of the ECO start/stop function
- Suspension:
 - Position of the exhaust gas flaps
 - Steering
 - Availability of glide mode
- ① You can also change the following vehicle characteristics using the buttons in the center console:
 - Position of the exhaust gas flaps
 - Suspension
 - ESP®
 - Availability of the ECO start/stop function

Displaying dynamic data

Multimedia system:

 Vehicle ▶  DYNAMIC SELECT

▶ Select Dyn. Data.

Dynamic data is displayed, e.g.:

- G-force values

14 Driving and parking

- Torque distribution
- Boost
- Current power output
- Variable all-wheel drive

Automatic transmission

Manual gearshifting

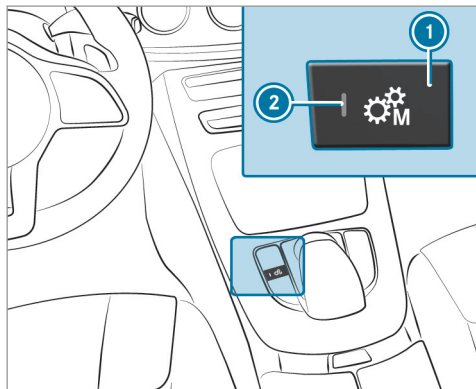

▶ **To activate/deactivate:** press button ①. If indicator lamp ② is lit, manual gearshifting is activated. The current gear is displayed in the multifunction display.

① To permanently shift the gears manually in drive program  using the steering wheel gearshift paddles, select the **M** (Manual) setting for the transmission.

! **NOTE** Damage to the engine due to shifting up too late

The automatic transmission does not shift up in manual mode even when the engine's limiting speed is reached.

The fuel supply is interrupted in order to prevent the engine from overrevving.

▶ Shift up before the engine speed reaches the red area in the tachometer.

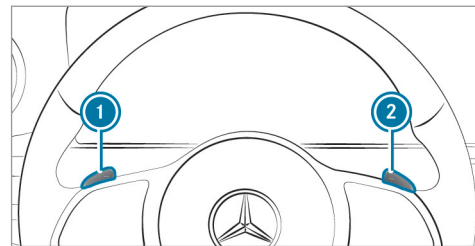

▶ **To shift up:** pull steering wheel gearshift paddle ②.

▶ **To shift down:** pull steering wheel gearshift paddle ①.

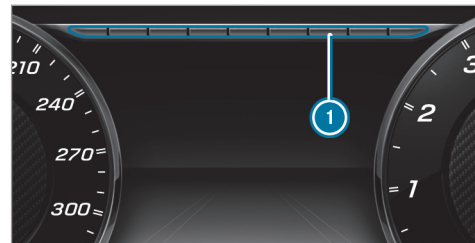

If the engine speed is too high or too low, you cannot change gear using the steering wheel gearshift paddles. In this case, segments ① light up red.

Gearshift recommendation

The gearshift recommendation assists you in adopting an economical driving style.

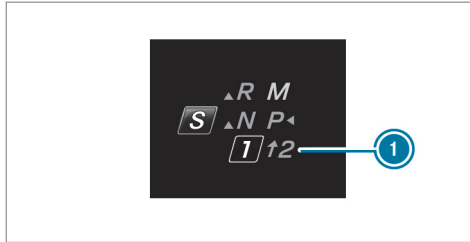

- ▶ If gearshift recommendation message ① is shown on the multifunction display, shift to the recommended gear.

- ① Gearshift recommendation is active only if you have activated manual gearshifting with the button on the center console.

Using kickdown

- ▶ **Maximum acceleration:** depress the accelerator pedal beyond the pressure point.

During kickdown, you cannot change gears using the steering wheel gearshift paddles. The automatic transmission shifts up to the next gear when the maximum engine speed is reached to protect the engine from overrevving.

- ① If you have activated manual gearshifting with the button in the center console, the transmission does not react to the kickdown.

Glide mode function

With an anticipatory driving style, glide mode helps you to reduce fuel consumption.

Glide mode is characterized by the following:

- The combustion engine is switched off. All of the vehicle functions remain active.
- The  symbol will appear on the multifunction display.

Glide mode is activated if the following conditions are met:

- The ECO start/stop function is switched on.
- Drive program  is selected with the drive setting "Moderate" or "Reduced".
- The speed is within a suitable range.
- The road's course is suitable, e.g. no steep uphill or downhill inclines or tight bends.
- The charge level of the battery is sufficient.
- You are no longer depressing the accelerator or brake pedal.

Glide mode is deactivated again if one of the conditions is no longer met.

When Active Distance Assist DISTRONIC is active, glide mode is not available.

Driving and driving safety systems

Functions of ESP® (Electronic Stability Program)

⚠ WARNING Risk of skidding if ESP® is malfunctioning

If ESP® is malfunctioning, ESP® cannot carry out vehicle stabilization. In addition, other driving safety systems are switched off.

- ▶ Drive on carefully.
- ▶ Have ESP® checked at a qualified specialist workshop.

You can select between the following modes of ESP®:

- ESP® ON
- ESP® SPORT
- ESP® OFF

Characteristics when ESP® is activated

ESP® monitors and improves driving stability and traction, particularly in the following situations:

- When pulling away on wet or slippery roadways.
- When braking.
- In strong side winds when you are driving faster than 47 mph (75 km/h).

ESP® can stabilize the vehicle by intervening in the following ways:

- One or more wheels are braked.
- The engine output is adapted according to the situation.

ESP® is activated every time the engine is started regardless of whether ESP® was in ESP® SPORT or deactivated before the engine was switched off.

If the  ESP® warning lamp flashes in the instrument cluster, one or several vehicle wheels has reached its grip limit:

- Adapt the driving style to suit the prevailing road and weather conditions.
- Do not deactivate ESP® under any circumstances.
- Only depress the accelerator pedal as far as is necessary.

Characteristics when ESP® SPORT is activated

⚠ WARNING Risk of skidding if ESP® SPORT is used incorrectly

When you activate ESP® SPORT, there is an increased risk of skidding and having an accident.

- ▶ Activate ESP® SPORT only in the circumstances described below.

Select ESP® SPORT when the vehicle's own oversteering and understeering characteristics are desired, e.g. on designated roads.

Driving with ESP® SPORT or with ESP® deactivated requires an extremely qualified and experienced driver.

If ESP® SPORT is activated and one or more wheels start to spin, the  ESP® warning lamp on the instrument cluster flashes. ESP® then only stabilizes the vehicle to a limited degree.

ESP® SPORT also has the following characteristics:

- ESP® only improves driving stability to a limited degree.
- ETS/4ETS traction control is still active.
- The engine's torque is only restricted to a limited degree and the drive wheels can spin.
The spinning of the wheels results in a cutting action for better traction on loose surfaces.
- ESP® continues to provide assistance when the brakes are firmly applied.
- Crosswind Assist is no longer active.

Characteristics when ESP® is deactivated

▲ WARNING Risk of skidding if ESP® is deactivated

If you deactivate ESP®, ESP® cannot carry out vehicle stabilization.

▶ ESP® should only be deactivated in the following situations.

When ESP® is deactivated, the  ESP® OFF warning lamp and the **ESP OFF** message light up continuously in the instrument cluster.

Deactivating ESP® has the following effects:

- Driving stability will no longer be improved.
 - The drive wheels could spin.
 - ETS/4ETS traction control is still active.
 - Crosswind Assist is no longer active.
- i** Even when ESP® is deactivated, you are still assisted by ESP® when braking hard.

It may be best to activate ESP® SPORT or deactivate ESP® in the following situations:

- When using snow chains.
 - In deep snow.
 - On sand or gravel.
- i** Spinning the wheels results in a cutting action, which enhances traction.
- i** Activate ESP® as soon as the situations described above no longer apply. ESP® will otherwise not be able to stabilize the vehicle if the vehicle starts to skid or a wheel starts to spin.

If the  ESP® warning lamp lights up continuously even when ESP® is activated, ESP® is not available due to a malfunction.

Observe any information which may be displayed in the instrument cluster:

- Warning and indicator lamps
- Display messages

ETS/4ETS (Electronic Traction System)

ETS/4ETS traction control is part of ESP®.

ETS/4ETS can improve the vehicle's traction by intervening in the following ways:

- The drive wheels are braked individually if they spin.
- More drive torque is transferred to the wheel or wheels with traction.

Activating/deactivating ESP® (Electronic Stability Program)

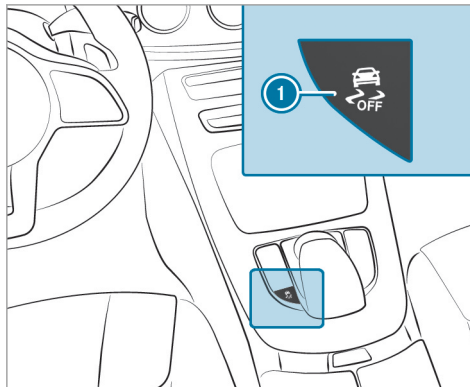

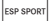
- ▶ **To activate ESP® SPORT:** briefly press button ①. The  and  warning lamps appear in the instrument cluster.

- ▶ **To deactivate ESP® SPORT:** briefly press button ①. The  and  warning lamps in the instrument cluster go out.
- ▶ **To deactivate ESP®:** press and hold button ① until the  and **ESP OFF** warning lamps appear in the instrument cluster.
- ▶ **To activate ESP®:** briefly press button ①. The  and **ESP OFF** warning lamps go out in the instrument cluster.

Observe the information on warning lamps and display messages which may be shown in the instrument cluster.

AMG adaptive sport suspension system

Function of the AMG adaptive sport suspension system

The AMG adaptive sport suspension system is an air suspension system with variable damping for improved driving characteristics. The all-round level control system ensures the best possible suspension and constant ground clearance, even with a laden vehicle. When driving at

speed, the vehicle is lowered automatically to improve driving safety and to reduce fuel consumption. You also have the option of manually adjusting the vehicle level.

The damping is adjusted individually for each wheel and is influenced by the following factors:

- The driving style, e.g. sporty
- The road condition, e.g. bumps
- The individual selection of "Sport", "Sport Plus", "Comfort" or "Economy"

The AMG adaptive sport suspension system includes the following components and functions:

- Air suspension with variable spring rate and automatic level control

- Speed-dependent lowering to reduce fuel consumption
- Manually selectable high level setting for greater ground clearance
- ADS PLUS (Adaptive Damping System with constant damping force adjustment)
- DYNAMIC SELECT switch and level button
- Suspension setting button

Available suspension settings

Drive program	Characteristics
C (Comfort) E (Eco)	<ul style="list-style-type: none">• The suspension setting is comfortable.• The vehicle is set to the normal level.• When driving at speeds above 100 mph (160 km/h) the vehicle is lowered.• When driving at speeds below 87 mph (140 km/h), the vehicle is raised again.
S (Sport)	<ul style="list-style-type: none">• The suspension setting is firmer.• The vehicle is set to the low level.• The vehicle is not lowered any further if you are traveling at higher speeds.
S⁺ (Sport Plus)	<ul style="list-style-type: none">• The suspension setting is even firmer.• The vehicle is set to the low level.• The vehicle is not lowered any further if you are traveling at higher speeds.

Selecting the AMG adaptive sport suspension system setting

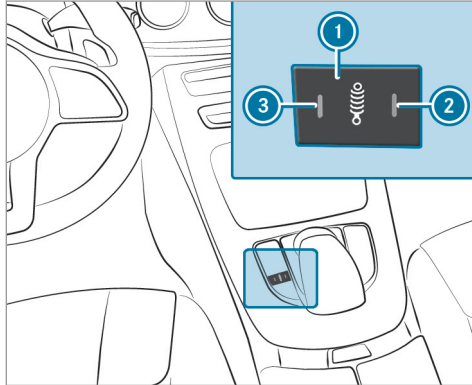

- ▶ **COMFORT suspension setting:** press button ① repeatedly until indicator lamps ② and ③ go out. The **AMG Suspension System COMFORT** message appears in the multifunction display.

The driving characteristics of your vehicle are comfortable.

- ▶ **SPORT suspension setting:** press button ① repeatedly until indicator lamp ③ lights up. The **AMG Suspension System SPORT** message appears in the multifunction display. The suspension is adapted to be firmer.
- ▶ **SPORT+ suspension setting:** press button ① repeatedly until indicator lamps ② and ③ light up. The **AMG Suspension System SPORT +** message appears in the multifunction display. The suspension is adapted to be very firm.

Setting the vehicle level

- ▲ **WARNING** Risk of accident because vehicle level is too high

If you drive at a higher vehicle level, the driving characteristics may be impaired due to the higher vehicle center of gravity.

The vehicle can drift outwards, for example, when steering or cornering.

- ▶ Always choose a vehicle level which is suited to the driving style and the road surface conditions.

- ▲ **WARNING** Risk of entrapment from vehicle lowering

When lowering the vehicle, people could become trapped if their limbs are between the vehicle body and the tires or underneath the vehicle.

- ▶ Make sure no one is underneath the vehicle or in the immediate vicinity of the wheel arches when the vehicle is being lowered.

- ▲ **WARNING** Risk of becoming trapped due to the vehicle lowering

Vehicles with AIR BODY CONTROL or level control system: when you unload luggage or leave the vehicle, the vehicle first rises slightly and then returns to the set level shortly afterwards.

22 Driving and parking

You or anyone else in the vicinity of the wheel arches or the underbody could thus become trapped.

The vehicle can also be lowered after being locked.

- ▶ When leaving the vehicle, make sure that nobody is in the vicinity of the wheel arches or the underbody.

Requirements:

- The vehicle has been started.
- The vehicle must not be moving faster than 40 mph (65 km/h).

Raising the vehicle

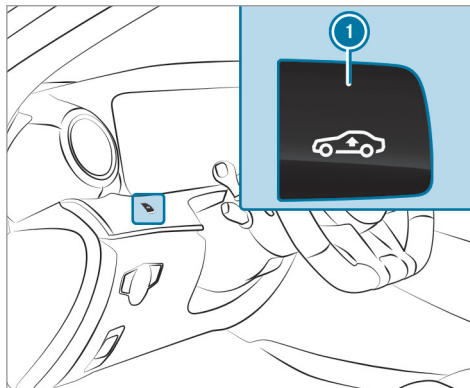

- ▶ Press button ①.
- ▶ The vehicle is raised to the high level.

Your selection is saved.

The vehicle is lowered again in the following situations:

- **Mercedes-AMG E 53 4MATIC+:** When driving faster than 62 mph (100 km/h).

- **Mercedes-AMG E 53 4MATIC+:** When driving between 50 mph (80 km/h) and 62 mph (100 km/h) for approximately three minutes.
- After selecting a drive program using the DYNAMIC SELECT switch.

The vehicle is adjusted to the height of the last active drive program.

Lowering the vehicle

- ▶ Press button ①.
- ▶ The vehicle is adjusted to the height of the last active drive program.

Function of the AMG steering-wheel buttons

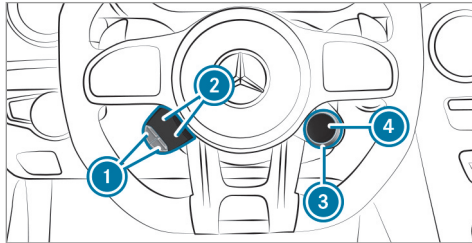

The AMG steering-wheel buttons are two additional control elements on the steering wheel.

You can assign two vehicle functions of your choice to the left control element. You can change between the available functions by pressing display buttons ② repeatedly. The currently selected functions are displayed in display buttons ②.

The following functions are available:

- ESP® (→ page 16)

- AMG adaptive sport suspension system (→ page 18)
- AMG Performance exhaust system (→ page 13)
- ECO start/stop function (→ page 12)
- Manual gearshifting (→ page 14)



If you have assigned a function to one of display buttons ②, you can operate this function with corresponding button ①.

The assignment of display buttons ② remains stored even after a new engine start, but the operating status of the respective function is reset to the basic setting.

You can change between the drive programs with rotary actuator ③. The selected drive program appears in display button ④. By pressing display button ④, you can directly access the drive program  (**Individual**).

Notes on the Instrument Display and on-board computer

Additional notes regarding your Mercedes-AMG vehicle:

- **Vehicles with an Instrument Display (standard) only:** if you select the **Performance** menu, the upshift bar will appear on the multifunction display.
- Additional note regarding the indicator and warning lamps: the vehicle is also equipped with the ESP® , ESP® OFF  and ESP® SPORT  indicator and warning lamps (→ page 41).
- You can select the following display content in vehicles with a Widescreen Cockpit:
 - Tachometer (classic display setting)
 - Date (progressive display setting)
 - Gear display
 - Warm-up
 - Track Pace
 - G-meter
 - Engine data

- Trip computer
- Navigation

Operating the on-board computer

⚠ WARNING Risk of distraction from information systems and communications equipment

If you operate information and communication equipment integrated in the vehicle when driving, you will be distracted from the traffic situation. This could also cause you to lose control of the vehicle.

- ▶ Only operate this equipment when the traffic situation permits.
- ▶ If you cannot be sure of this, stop the vehicle whilst paying attention to road and traffic conditions and operate the equipment with the vehicle stationary.

Observe the legal requirements for the country in which you are currently driving when operating the on-board computer.

i The on-board computer displays will appear on the multifunction display.

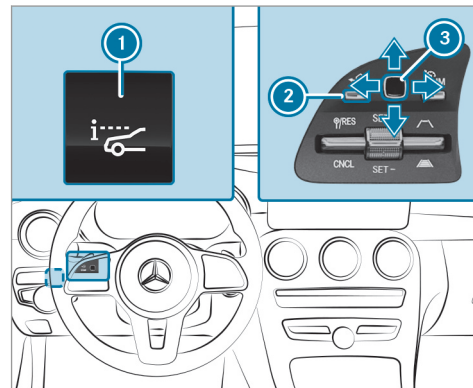

The on-board computer is operated using left-hand Touch Control **3** and left-hand back/home button **2**.

When the on-board computer is being operated, different acoustic signals will sound as operating feedback, e.g. when the end of a list is reached or when you are scrolling through a list.

The following menus are available:

- [Service](#)
- [DriveAssist](#)
- [Performance](#)
- [Trip](#)
- [Navigation](#)
- [Radio](#)
- [Media](#)
- [Phone](#)
- [Head-up Disp.](#)
- **Vehicles with an Instrument Display in the Widescreen Cockpit:** [Designs](#)

Vehicles with an Instrument Display (standard) only: If you select the [Performance](#) menu, the upshift bar, the transmission set-up **M** (manual) and the current gear will appear on the multifunction display.

The menus can be called up from the menu bar on the multifunction display.

- ▶ **To call up the menu bar:** press back button on the left ② until the menu bar is displayed.

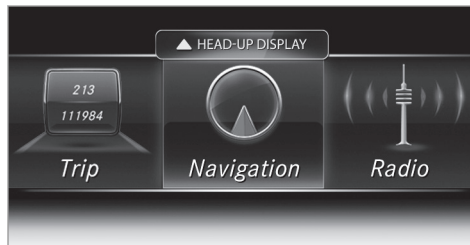

- ▶ **To scroll in the menu bar:** swipe left or right on left-hand Touch Control ③.
- ▶ **To call up a menu or confirm a selection:** press left-hand Touch Control ③.
- ▶ **To scroll through displays or lists on the menu:** swipe upwards or downwards on left-hand Touch Control ③.
- ▶ **To call up a submenu or confirm a selection:** press left-hand Touch Control ③.

- ▶ **To exit a submenu:** press back button on the left ②.

Selecting the Head-up Display

- ▶ **If the Head-up Display is switched off:** press button ①. The Head-up Display will be switched on.

or

- ▶ **If the Head-up Display is switched on:** swipe upwards on left-hand Touch Control ③. The Head-up Display will be activated.
- ▶ **To select what the Head-up Display shows:** swipe upwards or downwards on left-hand Touch Control ③.

Calling up displays on the Performance menu

On-board computer:

↳ [Performance](#)

- ▶ **To select a display:** swipe upwards or downwards on the left-hand Touch Control.

Displays on the **Performance** menu:

- Warm-up
- SETUP
- G-Meter
- RACETIMER (vehicles without AMG TRACK PACE)
- Engine data

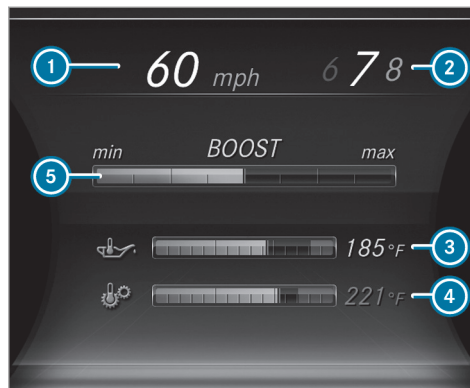

Warm-up (example)

- ① Digital speedometer
- ② Gear display
- ③ Engine oil temperature
- ④ Transmission oil temperature
- ⑤ Boost pressure

If the engine or transmission is not at operating temperature, the multifunction display will show

temperature ③ or ④ in blue. Avoid using the full engine power output during this time.



Example: SETUP

- ① Drive system setting:
Reduced/Moderate/Sport/Dynamic/Race
- ② Exhaust system:
Balanced/Powerful
- ③ ESP® status:
On/Off
- ④ Transmission position:
D/M
- ⑤ Suspension tuning:
Comfort/Sport/Sport+

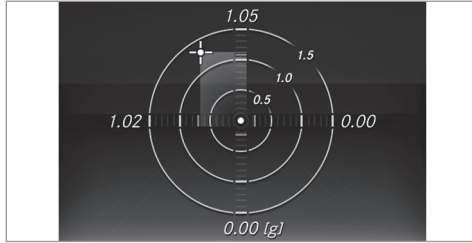

G-meter (example)

While the vehicle is in motion, the G-meter shows the forces that are exerted on the vehicle occupants both laterally and in the direction of travel. The maximum values appear in red in the coordinate system.

- ▶ **To reset the G-meter:** press the left-hand Touch Control.
- ▶ Select **Yes**.
- ▶ Press the left-hand Touch Control.

If you press and hold the left-hand Touch Control, the function will be reset immediately.

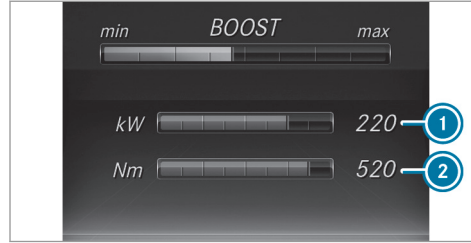

Engine data (example)

- ① Current power output
- ② Current torque

Displaying and starting RACE TIMER on the Performance menu

On-board computer:

↳ Performance

- ① The RACE TIMER function is available only in vehicles without AMG TRACK PACE.

The following functions are possible in the RACE TIMER:

- Selecting displays and starting
- Stopping
- Starting a new lap
- Displaying lap statistics
- Resetting

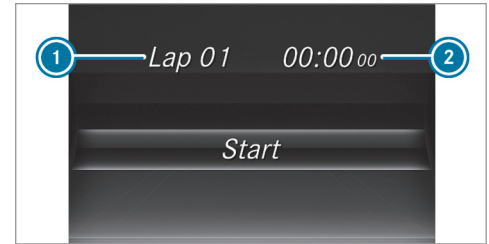

- ① Lap
- ② Lap time

RACE TIMER is intended only for use on designated race tracks. Do not use the function on public roads.

- ▶ **To select a display and start:** swipe up or down on the left-hand Touch Control.
- ▶ Press the left-hand Touch Control.
- ▶ Select **Start** and press the left-hand Touch Control.
- ▶ **To stop:** select **Stop** and press the left-hand Touch Control.
- ▶ **To start a new lap:** after the first stored lap, press the left-hand Touch Control.
- ▶ Select **New Lap**.
A maximum of 32 laps may be stored.



Example: RACE TIMER

- ① Lap
- ② Elapsed time
- ③ Average speed
- ④ Distance covered

- ▶ **To display the lap statistics:** after at least two stored laps, press the left-hand Touch Control.
- ▶ Select **Lap List**.
The lap statistics will be displayed.

- ▶ Display the statistics for the next lap by swiping up or down on the left-hand Touch Control.
The fastest lap is indicated by flashing text ①.
- ▶ **To reset:** stop RACE TIMER and press the left-hand Touch Control.
- ▶ Select **Reset** and press the left-hand Touch Control.
All laps will be deleted.

Function of the Head-up Display

The Head-up Display projects the following content into the driver's field of vision:

- Information from the navigation system
- Information from the driver assistance systems
- Some warning messages

Mercedes-AMG display content

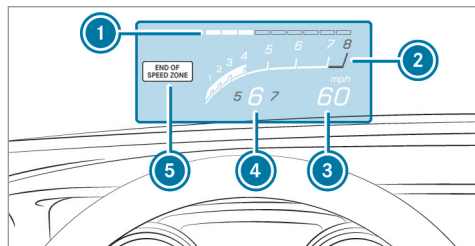

- ① Protection from reaching the overrevving range
- ② Current engine speed
- ③ Current speed
- ④ Currently selected gear, gearshift options with manual shifting
- ⑤ Detected instructions and traffic signs

Depending on the vehicle's equipment, you can select further AMG displays in addition to the standard displays on the [Display Content](#) menu. If you select RACETIMER, the Head-up Display will show the lap and lap time.

In vehicles with AMG TRACK PACE, you can also display additional content depending on the setting:

- Speed and gear display
- Lap and sector times
- Acceleration and braking
- Track layout graphics

When you receive a call, the  **Incoming Call** message will appear on the Head-up Display.

In audio mode, the station name or track will be shown temporarily when the audio source is being actively operated.

System limitations

The visibility is influenced by the following conditions:

- Seat position
- The positioning of the display image
- Light conditions
- Wet roads
- Objects on the display cover
- Polarization in sunglasses

- ① In extreme sunlight, sections of the display may appear washed out. You can correct this by switching the Head-up Display off and on again.

AMG TRACK PACE

General information

With AMG TRACK PACE, the driving characteristics on race tracks can be analyzed and optimized. You can drive previously stored race tracks (e.g. Hockenheimring), or new tracks can be recorded and stored. The driven lap times are stored for every track. These can be analyzed and compared to other lap times to achieve the best possible race results. Additionally, acceleration and braking procedures can be measured and stored.

Please note: Use AMG TRACK PACE only on closed-off routes outside the public traffic area. Adapt your driving style to your personal abilities and the environmental conditions. As the driver, you are solely responsible for driving your vehicle. Park your vehicle safely before operating the application.

Setting Track Race

Multimedia system:

↳ Vehicle ▶ TRACK PACE ▶ Track Race

Recording a track

- ▶ Select **Record Track**.
- ▶ At the desired starting point, select **Start Record**.
The track recording starts at this point. During track recording, sectors can be set to determine intervals.
- ▶ To finish track recording, select **Stop** or cross the starting line again.
- ▶ Enter the weather and the track name.

Searching by track name

- ▶ Select **All Tracks**.
- ▶ Select  **Search**.
- ▶ Enter the track name.
Tracks with the searched name are displayed.

Measuring the time on the track

- ▶ Select **Timing**.
An overview of nearby tracks appears. The distance and direction to the starting line of the track is displayed.
- ▶ Select the desired track.
If you have already driven on this track, you can select a driven time as a reference time.

Timekeeping begins automatically when the starting line has been crossed.

- ⓘ When **Zoom** is selected, the track display can be switched from 2D to 3D.

Displaying the analysis

- ▶ Select **Lap Times**.
An overview of all the driven tracks appears.
- ▶ Select a track.
The following data is displayed:
 - Lap and sector times
 - Average and maximum permissible speed
 - Driver
 - Vehicle

- Date
 - Weather
- ▶ Select a desired lap.
The analysis is displayed.

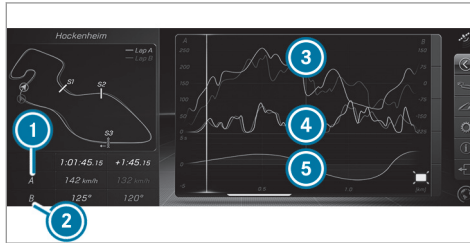

- 1 Parameter 1 (e.g. speed)
- 2 Parameter 2 (e.g. steering angle)
- 3 Speed trend (Parameter 1)
- 4 Steering angle trend (Parameter 2)
- 5 Time difference between lap A and B (only when two laps are selected).

ⓘ The following values can be set for parameters 1 and 2, for example:



- Speed
- Longitudinal/lateral acceleration
- Steering angle
- Engine speed
- Engine oil/tire temperature

Based on the analysis you can check and optimize driving characteristics for any position on the track.

Exporting tracks or races (USB)

- ▶ Select **All Tracks**.
An overview of all stored tracks and races appears.
- ▶ Highlight desired tracks or races.
- ▶ Select  Options.
- ▶ Select **Export**.
The selected tracks or races can be exported to a USB storage device connected to the vehicle.

Editing tracks and recordings

- ▶ Select **All Tracks**.
 - ▶ Highlight the desired track.
 - ▶ Select  options.
 - ▶ Select **Rename** or **Delete**.
- or
- ▶ Select a track.
 - ▶ Highlight the desired recording.
 - ▶ Select  options.
 - ▶ Select **Weather** or **Delete**.

Setting Drag Race

Multimedia system:

↳ **Vehicle** ▶ **TRACK PAGE** ▶ **Drag Race**

Measuring acceleration

- ▶ Select **Acceleration**.
Measurement begins when the vehicle accelerates. Measurement is incremental, in steps of 30 mph (50 km/h) to a maximum of 180 mph (300 km/h) or up to the set maximum speed.

Measurement can be stopped early by selecting **Stop** or by stopping the vehicle.

Quarter-mile race

▶ Select **Quarter Mile**.
The time measurement runs until a mile has been traveled or a previously set distance (e.g. 1/4 mile, 1/3 mile or 1/2 mile) has been reached.

ⓘ The possible values for setting the end distance are determined by the system and cannot be freely chosen.

Measurement can be stopped early by selecting **Stop** or by stopping the vehicle.

Manual start for acceleration and quarter-mile race

▶ Select **Acceleration** or **Quarter Mile**.
▶ Select **Manual start**.
Three red traffic lights appear one after the other. The reaction time measurement starts when they change to green at the same time. The reaction time is displayed as soon as you drive off. If you drive off too early, the message **Jump start** will appear and acceleration

or quarter mile measurement will be canceled.

Measuring braking

▶ Select **Braking**.
▶ Select **Start Record**.
Measurement is incremental, in steps of 30 mph (50 km/h) to a standstill. If the braking procedure is started e.g. at a speed of 99 mph (160 km/h), measurement starts as soon as 90 mph (150 km/h) has been reached.

Storing and calling up measurement values

When a measurement has been completed or canceled, the measured time can be stored.

▶ After a measurement, select **Save measurement?** .

The stored measurements can be displayed via the **History** menu item.

Editing measurements

▶ Select **History**.
▶ Highlight the desired measurement.

▶ Select  options.

▶ Select **Weather** or **Delete**.

ⓘ The measurements can be displayed by category, e.g. acceleration measurements, by applying a filter.

Calling up the telemetry display

Multimedia system:

↳ **Vehicle** ▶ **TRACK PACE** ▶ **Telemetry**

The telemetry display shows current vehicle data as a digital value and as a diagram. Up to four parameters can be selected that are to be shown in the display.

For example:

- Engine speed
- Wheel angle
- Speed
- Steering angle

▶ Set the desired parameters.

- ▶ Set the time.
The set parameters are evaluated in the diagram for the time set.
- ⓘ The time can range between 30 seconds and a maximum of 20 minutes.

Configuring AMG TRACK PACE

Requirements

To use the TRACK PACE app:

- The TRACK PACE app is installed on the mobile end device.
- The mobile end device is connected to the multimedia system via Wi-Fi.

Multimedia system:

↳ Vehicle ▶▶ TRACK PACE ▶▶ Options

Setting driver profiles

- ▶ Select [Driver Profile](#).
- ▶ Create a new driver profile.

or

- ▶ Select an existing driver profile.
The driver profile is activated.

- ⓘ Tracks, laps and times driven are assigned to the active driver profile while driving. For an exact evaluation of your driving style, you should always drive with an active driver profile.

Displaying driver profile statistics

- ▶ Select [Driver Profile](#).
- ▶ Select the desired profile.

The following information is displayed for the selected driver profile:

- Driving time
- Track driven
- Number of Track Races, Drag Races and laps driven
- Maximum speed

Connecting a mobile device via the TRACK PACE app

The TRACK PACE app makes it possible to record videos and to synchronize them with stored tracks.

- ▶ Select the [TRACK PACE App](#).
Already authorized devices are displayed in the list.
- ▶ Select [Authorize new device](#).
Available devices are displayed.
- ▶ Start the TRACK PACE app on the device to be connected and follow the instructions.
- ▶ Confirm the authorization prompt.
- ▶ Enter the code displayed on the device.
The device is authorized.

or

- ▶ Select a device that is already authorized.
The device is de-authorized.

Setting the TRACK PACE display in the head-up display

- ▶ Select [HUD Contents](#).
- ▶ Activate or deactivate the desired contents.
The contents in the Head-up Display are adapted.

- ⓘ For further information on the Head-up Display, see (→ page 28).

Setting acoustic feedback

▶ Select [Acoustic feedback](#).

The following settings are available:

- [Loud](#)
- [Medium](#)
- [Quiet](#)
- [Off](#)

▶ Select a setting.

Activating/deactivating additional information

▶ Activate or deactivate [Display help](#).

When additional information is activated, popups provide information on the individual menus.

▶ Confirm popups with [OK](#) or select [Do not display](#).

Calling up information

▶ Select [Info](#).

The following information is displayed:

- Software version
- Memory used

- Total number of tracks saved
- Total number of races driven

Flat tire

TIREFIT kit storage location

The TIREFIT kit is located under the trunk floor.

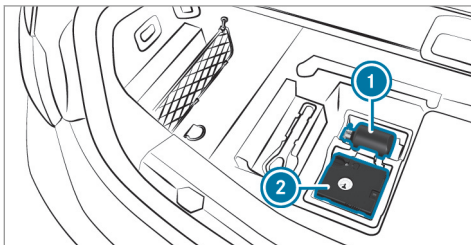

- ① Tire sealant bottle
- ② Tire inflation compressor

Changing a wheel

- ▶ Be sure to also observe the notes on changing a wheel in the Operator's Manual of your vehicle.

▶ Only use tire types that have been approved for the maximum road speed set and the vehicle.

Vehicles with AMG Driver's Package:

⚠ WARNING Risk of accident caused by non-approved tire types

If you use tire types that have not been adapted to changes made to the factory speed limit, this can have the following consequences:

- The tires do not exhibit the required quality characteristics and are not suitable for high speeds or the relevant driving dynamics.
- The tires wear unevenly and could, therefore, affect the roadworthiness of the vehicle.
- ABS, ESP[®] and cruise control operation are restricted.

This can jeopardize road safety.

Operating fluids

Fuel

Information on fuel grades for Mercedes-AMG vehicles

Observe the information on operating fluids in the vehicle Operator's Manual.

! **NOTE** Damage caused by the wrong fuel

Even small amounts of the wrong fuel could result in damage to the fuel system, the engine and the emission control system.

- ▶ Only refuel with low-sulfur unleaded fuel.

This fuel may contain up to 10% ethanol by volume. Your vehicle is suitable for use with E10 fuel.

Never refuel with one of the following fuels:

- Diesel
- Gasoline with more than 10% ethanol by volume, e.g. E15, E85, E100

- Gasoline with more than 3% methanol by volume, e.g. M15, M30, M85, M100
- Gasoline with additives containing metal

If you have accidentally refueled with the wrong fuel:

- ▶ Do not switch the ignition on.
- ▶ Consult a qualified specialist workshop.

If the available fuel is not sufficiently low in sulfur, this can produce unpleasant odors.

Only refuel using unleaded premium grade gasoline with at least 91 AKI/95 RON.

As a temporary measure, if the recommended fuel is not available, you may also use unleaded regular gasoline which has at least the octane number specified in the information label in the fuel filler flap (see the vehicle Operator's Manual).

Never refuel using gasoline with an even lower RON.

! **NOTE** Premature wear through unleaded regular gasoline

Unleaded regular gasoline can cause the engine to wear more quickly and impair longevity and performance.

If unleaded premium grade gasoline is unavailable and you have to refuel using unleaded regular gasoline:

- ▶ Only fill the fuel tank to half full with unleaded regular gasoline and fill up as soon as possible with unleaded premium grade gasoline.
- ▶ Do not drive at the maximum design speed.
- ▶ Avoid sudden acceleration and engine speeds over 3000 rpm.

Further information on fuel is available at the following locations:

- At a gas station
- At a qualified specialist workshop
- On the <https://www.mbusa.com> (USA only)

Tank content and fuel reserve**Capacity**

Model	Total capacity
Mercedes-AMG E 53 4MATIC+	17.4 gal (66.0 liters)
Model	Of which reserve
Mercedes-AMG E 53 4MATIC+	1.8 gal (7.0 liters)

Quality and capacity of engine oil**MB-Freigabe or MB-Approval**

Model	Engine oil specifications
Mercedes-AMG E 53 4MATIC+	229.51, 229.52, 229.61 229.71*

* Recommended for lowest possible fuel consumption (lowest SAE viscosity class in each

case; observe possible restrictions of the approved SAE viscosity classes).

To achieve the lowest possible fuel consumption, it is recommended to use the engine oil specifications marked in the table for the lowest SAE viscosity class. Possible restrictions of the approved SAE viscosity classes must be observed.

The following values refer to an oil change, including the oil filter.

Capacity

Model	Capacity
Mercedes-AMG E 53 4MATIC+	9.0 US qt (8.5 liters)

Coolant capacity**Capacity**

Model	Capacity
Mercedes-AMG E 53 4MATIC+	14.8 US qt (14.0 liters)

Refrigerant filling capacity**Filling capacity for refrigerant and PAG oil**

Model	Refrigerant
Mercedes-AMG E 53 4MATIC+	20.8 ± 0.4 oz (590 ± 10 g)
Model	PAG oil
Mercedes-AMG E 53 4MATIC+	4.2 ± 0.4 oz (120 ± 10 g)

Vehicle data**Vehicle dimensions**

The heights specified may vary as a result of the following factors:

- Tires
- Load
- Condition of the suspension
- Optional equipment

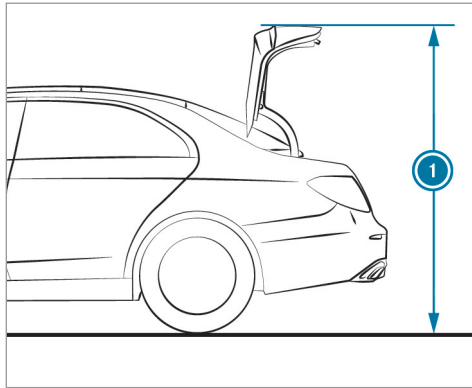

Missing values were not available at the time of going to press.

Height when opened

Model	Height when opened
Mercedes-AMG E 53 4MATIC +	61.6 in (1565 mm)

Vehicle dimensions

Mercedes-AMG E 53 4MATIC+	
Vehicle length	190.6 in (4842 mm)
Vehicle width including outside mirrors	80.9 in (2055 mm)
Vehicle height	56.2 in (1428 mm)
Vehicle height when opening/closing the roof	
Wheelbase	113.1 in (2873 mm)
Turning radius	39.7 ft (12.10 m)

Weights and loads

Please observe the following notes for the specified vehicle data:

- items of optional equipment increase the curb weight and reduce the payload.

Maximum design speeds

Missing values were not available at time of going to print.

The following values only apply to vehicles with the AMG Driver's Package.

Maximum design speeds

Mercedes-AMG E 53 4MATIC+	Maximum speed
1st gear	31 mph (50 km/h)
2nd gear	52 mph (83 km/h)
3rd gear	74 mph (119 km/h)
4th gear	102 mph (164 km/h)

40 Technical data

Mercedes-AMG E 53 4MATIC+	Maximum speed
5th gear	137 mph (221 km/h)
6th gear	155 mph (250 km/h)
7th gear	155 mph (250 km/h)
8th gear	
9th gear	

Display messages

Driving systems

Display messages	Possible causes/consequences and ► Solutions
 <p data-bbox="195 425 454 477">Malfunction Drive at Max. 50 mph</p>	<p data-bbox="524 332 1689 381">* The AMG adaptive sport suspension system is malfunctioning. The vehicle's handling characteristics may be affected.</p> <ul style="list-style-type: none"> <li data-bbox="543 394 1134 420">► Do not drive at speeds greater than 50 mph (80 km/h). <li data-bbox="543 427 975 453">► Consult a qualified specialist workshop.

Warning and indicator lamps

Driving safety systems

Warning/indicator lamp	Possible causes/consequences and ► Solutions
 <p data-bbox="195 795 436 821">ESP® OFF warning lamp</p>	<p data-bbox="504 702 1184 728">The yellow ESP® OFF warning lamp is lit while the engine is running.</p> <p data-bbox="515 738 735 764">*ESP® is deactivated.</p>

42 Display messages and warning/indicator lamps

Warning/indicator lamp	Possible causes/consequences and ► Solutions
	<p data-bbox="482 249 1644 288">▲ WARNING Risk of skidding when driving with ESP® deactivated</p> <p data-bbox="482 291 1644 353">If ESP® is deactivated, ESP® cannot carry out vehicle stabilization. The availability of further driving safety systems is also limited.</p> <ul data-bbox="482 356 1644 425" style="list-style-type: none"><li data-bbox="482 356 1644 384">► Drive on carefully.<li data-bbox="482 387 1644 425">► Only deactivate ESP® for as long as the situation requires. <p data-bbox="482 428 1644 467">If ESP® cannot be activated, ESP® is malfunctioning.</p> <ul data-bbox="482 470 1644 508" style="list-style-type: none"><li data-bbox="482 470 1644 508">► Have ESP® checked immediately at a qualified specialist workshop. <p data-bbox="482 532 1644 570">► Observe the notes on deactivating ESP® (→ page 16).</p>
<p data-bbox="158 588 310 671">ESP SPORT</p> <p data-bbox="131 674 439 712">ESP® SPORT warning lamp</p>	<p data-bbox="445 581 1644 619">ESP® SPORT is activated while the engine is running.</p> <p data-bbox="445 622 1644 660">*When ESP® SPORT is activated, ESP® will stabilize the vehicle only to a limited extent.</p> <p data-bbox="482 664 1644 702">▲ WARNING Risk of skidding if ESP® SPORT is used incorrectly</p> <p data-bbox="482 705 1644 743">When you activate ESP® SPORT, there is an increased risk of skidding and having an accident.</p> <ul data-bbox="482 746 1644 785" style="list-style-type: none"><li data-bbox="482 746 1644 785">► Activate ESP® SPORT only in the circumstances described below. <p data-bbox="482 809 1644 847">► Observe the notes on activating ESP® SPORT(→ page 16).</p>

Driving systems

Warning/indicator lamp	Possible causes/consequences and ► Solutions
 <p data-bbox="194 383 462 404">Suspension warning lamp</p>	<p data-bbox="508 290 1201 315">The yellow AMG adaptive sport suspension system warning lamp is lit.</p> <ul data-bbox="508 321 1219 383" style="list-style-type: none">* There is a malfunction in the AMG adaptive sport suspension system.<ul style="list-style-type: none">► Note the messages on the multifunction display.

A**Acceleration**

see Kickdown

AMG

Menu (on-board computer) 24
 Steering wheel control element 23
 Steering-wheel buttons 23

AMG adaptive sport suspension system

..... 21
 Selecting the suspension setting 21
 Setting 21
 Suspension 18

AMG Performance adjustable exhaust system

..... 13
 Function 12
 Operating 13

AMG Performance steering wheel 23**AMG TRACK PACE**

Configuring 33
 Drag Race 31
 General information 30
 Telemetry display 32
 Track Race 30

Authorized Mercedes-Benz Center

see Qualified specialist workshop

Authorized workshop

see Qualified specialist workshop

Automatic engine start (ECO start/stop function) 12**Automatic engine stop (ECO start/stop function)** 12**Automatic transmission**

Drive programs 13
 DYNAMIC SELECT switch 13
 Kickdown 15
 Manual gearshifting 14
 Oil temperature (on-board computer, Performance menu) 25
 Steering wheel paddle shifters 14

B**Boost pressure (on-board computer, Performance menu)** 25**Brakes**

New/replaced brakepads/brake discs .. 11
 Notes on breaking-in a new vehicle 11

C**Changing a wheel**

Mounting a new wheel 36
 Removing a wheel 36

Changing gears 14

Manually 14

Climate control

Filling capacity for PAG oil 38
 Refrigerant filling capacity 38

Cockpit 4

Overview 4

Comfort mode

see AMG adaptive sport suspension system

Computer

see On-board computer

Coolant (engine)

Filling capacity 38

D**Dashboard**

see Cockpit

- Dealership**
see Qualified specialist workshop
- Display messages**
 **Malfunction Drive at Max. 50 mph** 41
- Drag Race**
Setting 31
- Drive programs**
see DYNAMIC SELECT
- Driving safety system**
ESP® (Electronic Stability Program) 16
- Driving system**
AMG adaptive sport suspension system 18
- Driving tips**
Notes on breaking-in a new vehicle 11
- Dynamic data**
Displaying 13
- DYNAMIC SELECT** 13
Drive programs 13
Function 13
- E**
- E10** 37
- ECO start/stop function** 12
Automatic engine start 12
Automatic engine stop 12
Method of operation 12
- Emotion Start**
Starting the vehicle 11
- Engine**
ECO start/stop function 12
- Engine oil**
Capacity 38
MB-Freigabe or MB-Approval 38
Quality 38
Temperature (on-board computer, Performance menu) 25
- ESP® (Electronic Stability Program)**
Activating/deactivating 18
ESP® SPORT 16
Function/notes 16
Status display (on-board computer, Performance menu) 25
- ESP® SPORT**
Function/notes 16
- F**
- Fuel**
E10 37
Flexible fuel vehicles 37
Fuel reserve 38
Gasoline 37
Quality (gasoline) 37
Sulfur content 37
Tank content 38
- G**
- G-meter (on-board computer, Performance menu)** 25
- Gasoline** 37
- Gear display (on-board computer, Performance menu)** 25
- Gearshift recommendation** 15
- Glide mode** 15

H		N		Q	
Head-up Display		Notes on breaking-in a new vehicle	11	Qualified specialist workshop	8
Function	28	O		R	
I		On-board computer	24	RACETIMER (on-board computer, Performance menu)	27
Instrument display		AMG menu	24	Reserve	
AMG displays	24	Menu overview	24	Fuel	38
K		Operating	24	Roof load	39
Kickdown	15	Performance menu	24, 25	S	
Using	15	Operating fluids		Seat belt extender	10
L		Fuel (gasoline)	37	Seat belts	
Limited Warranty		Operating safety		Seat belt extender	10
Vehicle	9	Information	7	Selecting a gear	
M		Operating system		see Changing gears	
Maximum speeds	39	see On-board computer		Service center	
Menu (on-board computer)		Operator's Manual		see Qualified specialist workshop	
AMG displays	24	Vehicle equipment	7	SETUP (on-board computer, Performance menu)	25
Overview	24	P		Shift paddles	
Performance	24, 25	Performance (on-board computer, Performance menu)	25	see Steering wheel paddle shifters	
		Power output (on-board computer, Performance menu)	25		

Shifting gears	
Gearshift recommendation	15
Specialist workshop	8
Sport Plus suspension setting	
see AMG adaptive sport suspension system	
Sport suspension setting	
see AMG adaptive sport suspension system	
Sports exhaust	
see AMG Performance adjustable exhaust system	
Start/Stop button	
Emotion Start	11
Start/stop function	
see ECO start/stop function	
Steering wheel paddle shifters	14
Sulfur content	37
Suspension	
AMG adaptive sport suspension system	18
Selecting the suspension setting	21
Setting the suspension level	21
Suspension level	
Setting	21

T

Tank content

Fuel	38
Reserve (fuel)	38

Telemetry display

Calling up	32
------------------	----

Temperature

Engine oil (on-board computer, Performance menu)	25
Transmission oil (on-board computer, Performance menu)	25

Tire inflation compressor

see TIREFIT kit

TIREFIT kit	35
Storage location	35

Tires

Mounting	36
Removing	36

Tool

see Vehicle tool kit

Torque (on-board computer, Performance menu)	25
---	----

Touch Control

On-board computer	24
-------------------------	----

Track Race

Setting	30
---------------	----

Trunk lid

Opening dimensions	38
--------------------------	----

V

Vehicle

Correct use	9
Equipment	7
Limited Warranty	9
Qualified specialist workshop	8
Starting (Emotion Start)	11

Vehicle data

Maximum speeds	39
Roof load	39
Turning circle	38
Vehicle height	38
Vehicle length	38
Vehicle width	38
Wheelbase	38



Vehicle dimensions	38
---------------------------------	----

Vehicle tool kit	35
TIREFIT kit	35

W

Warm-up (on-board computer, Performance menu)	25
--	----

Warning/indicator lamp

 ESP® OFF warning lamp	41
 ESP® SPORT warning lamp	42
 Suspension warning lamp	43

Warranty	9
-----------------------	---

Wheels

Mounting	36
Removing	36

Workshop

 see Qualified specialist workshop